



Sutton Lane North London W4

£345 per week - Available 05/09/2015

**HAMPTONS**  
INTERNATIONAL

*Beyond your expectations*

# Sutton Lane North London W4

£345 per week - Available 05/09/2015

**HAMPTONS**  
INTERNATIONAL

*A stunning one double bedroom ground floor flat located in one of Chiswick's premier Mansion blocks overlooking Turnham Green featuring eat in kitchen and high ceilings.*

One Double Bedroom | One Bathroom | Eat In Kitchen | Furnished | Permit Parking | Central Location.

## Description

A stunning one double bedroom ground floor flat located in one of Chiswick's premier Mansion blocks overlooking Turnham Green featuring eat in kitchen and high ceilings. The property comprises double bedroom, modern kitchen & bathroom and spacious reception room. Sutton Lane North is moments away from the High Road shops and bars and Chiswick Park Tube is close by.

## Furnishing

Furnished



Exterior



Kitchen

## Hamptons Chiswick Lettings

48 Turnham Green Terrace, Chiswick

London W4 1QP

Tel: 0208 987 8443 - [chiswicklettings@hamptons-int.com](mailto:chiswicklettings@hamptons-int.com)

[www.hamptons.co.uk](http://www.hamptons.co.uk)

## ARLINGTON MANSIONS

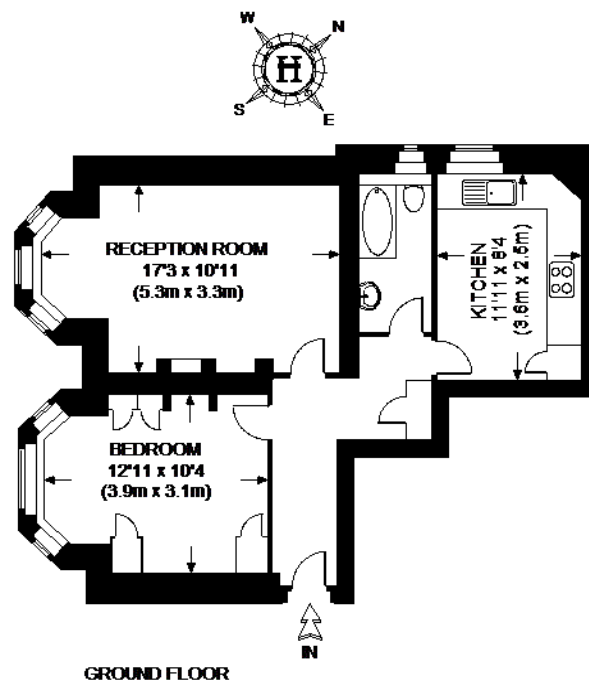

APPROXIMATE GROSS INTERNAL AREA =

TOTAL = 534 SQ. FT. (49.6 SQ. M.)

This plan is for layout guidance only. Not drawn to scale unless stated. Windows & door openings are approximate. Whilst every care is taken in the preparation of this plan, please check all dimensions, shapes & compass bearings before making any decisions reliant upon them. Please be advised that Hamptons International / our agents have not seen or reviewed any building regulations or planning permission in relation to works carried out to the property.

**For clarification,** we wish to inform prospective purchasers that we have prepared these sales particulars as a general guide. We have not verified permissions, nor carried out a survey, tested the services, appliances and specific fittings. Room sizes are approximate and rounded: they are taken between internal wall surfaces and therefore include cupboards/shelves, etc. Accordingly, they should not be relied upon for carpets and furnishings. It should also be noted that all fixtures and fittings, carpeted, curtains/blinds, kitchen equipment and garden statuary, whether fitted or not, are deemed removable by the vendor unless specifically itemised with these particulars.

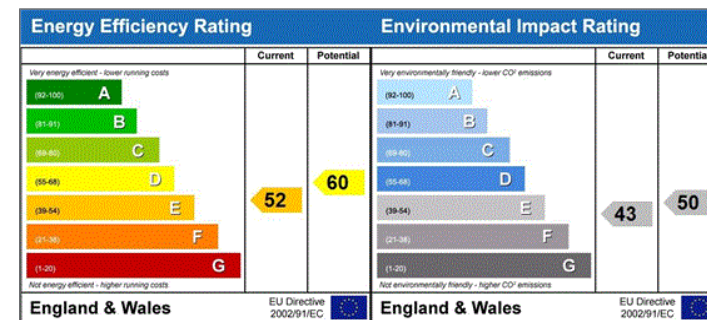

## Hamptons Chiswick Lettings

48 Turnham Green Terrace, Chiswick

London W4 1QP

Tel: 0208 987 8443 - [chiswicklettings@hamptons-int.com](mailto:chiswicklettings@hamptons-int.com)

[www.hamptons.co.uk](http://www.hamptons.co.uk)

**HAMPTONS**  
INTERNATIONAL

Beyond your expectations